

Superfinishing Attachments Series 130/140

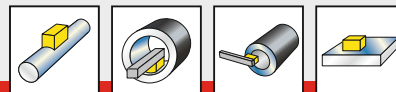
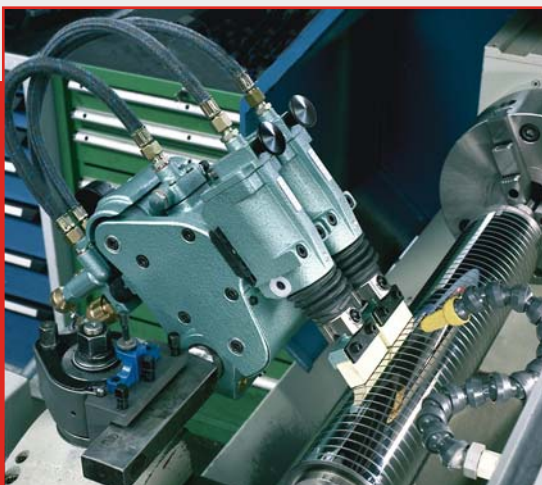

Pneumatic superfinishing attachment for mounting on medium and large sized carrier machines for superfinishing of ground and turned surfaces. Well-suited for high machining work on large workpieces with large superfinishing stones. In addition to cylindrical components, the attachment can also be used on flat, lightly convex or lightly concave surfaces and bores.

Superfinishing Attachments Series 130/140

supfina

The superfinishing attachments from the series 130/140 are designed for the daily use. The rugged, pneumatically operated oscillator works with resistant transfer elements to ensure balanced running. The complete oscillator drive runs on precision ball guides which ensures a precise parallel movement to the workpiece surface. The oscillation frequency and the vibration amplitude are adjusted with a valve. The stone guides are actuated pneumatically and the contact pressure of the superfinishing stone is finely adjustable. The wear of the superfinishing tool is automatically compensated for.

Technical Specifications	Supfina 130	Supfina 140
Frequency DH/min, max	2200	2800
min	2000	2500
Amplitude in mm	3-6	1-2.5
Air pressure in bar	4	4
Air consumption in Nm ³ /h	8-10	8-10
Weight in kg	26	25.8
Stone guide type	22.01	22.01
Extra stone guide for high bounds (measure A ₁) type	22.10	22.10
No. of stone guides	25	25
No. of stone guides	2-3	2-3

Dimensions		Supfina 130	Supfina 140
in mm	A ₁	150	150
	A	70	70
	B	310	310
	C	420	420
	D	177	177
	E	280	280
	F	147	147
	G	50x50	50x50
Compressed air connection		NW 6 DIN 7608	

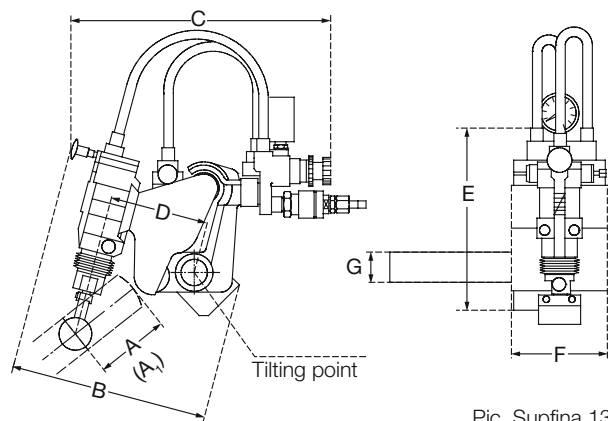

Pic. Supfina 130

Superfinish Know-how

Our customer service personnel are also specially trained in superfinishing abrasives. The expert advice of a specialist can often eliminate manufacturing problems and minimize expensive experimentation.



Accessories

Double and triple stone holders are available upon request, for larger workpiece diameter.



Stone holders for internal machining of bores with a diameter down to 45 mm and bore depth up to 140 mm.



Pneumatic control units make a remote control and the selection of the essential operating time of the attachment possible.



Coolant Filter Unit;

The superfinishing process requires ample flushing to the work surface. A built in filter ensures that the flushing agent will remain clean.

